

Eclipse ImmersoPak Burners

Model IP012

Version 2

Parameter	Modulating Air		
	Nat Gas	Propane	Butane
High Fire kBtu/hr. (kW) @ 3% O ₂	4100 (1200)	3900 (1143)	3900 (1143)
Low Fire kBtu/Hr. (kW)	275 (80.5)	250 (73)	300 (88)
High Fire CO (ppm) @ 3% O ₂	<10	<10	<10
Orifice Size (mm)	24	19	18
Air Pressure "w.c. (mbar) @ Max. Input – Air Pressure at burner inlet (Tap "A")	15 (37.4)		
Main Gas Pressure "w.c. (mbar)	Maximum	138.5 (345)	
	Minimum	20 (50)	
	Recommended	24 (60)	
Weight – less actuator lbs. (kg)	164 (74.4)		
Blower Type	15" Packaged		
Gas Piping	N.P.T. or B.S.P.		
Flame Detection	U.V. Scanner		

- All information is based on laboratory testing with a 12" diameter tube effective length of 50 feet. Different tube sizes and conditions (including backpressure) may affect the data.
- All information is based on standard tube design. Changes in the tube will alter performance and pressures.
- All inputs based upon gross calorific values.
- Plumbing of air and gas will affect accuracy of orifice readings. All information is based on generally acceptable air and gas piping practices.
- For 65% to 80% efficiency at high fire, tube length should be 35 to 82 feet long.
- Eclipse reserves the right to change the construction and/or configuration of our products at any time without being obliged to adjust earlier supplies accordingly.

Performance Graphs

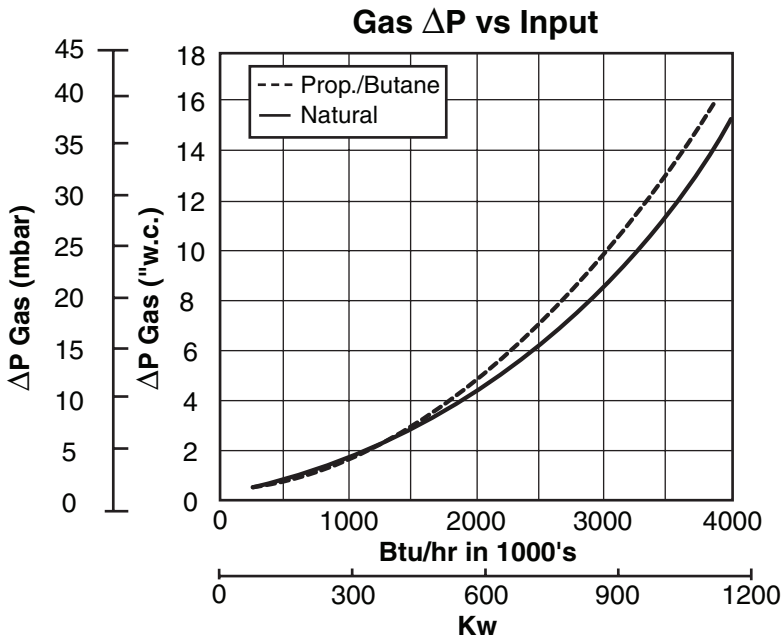
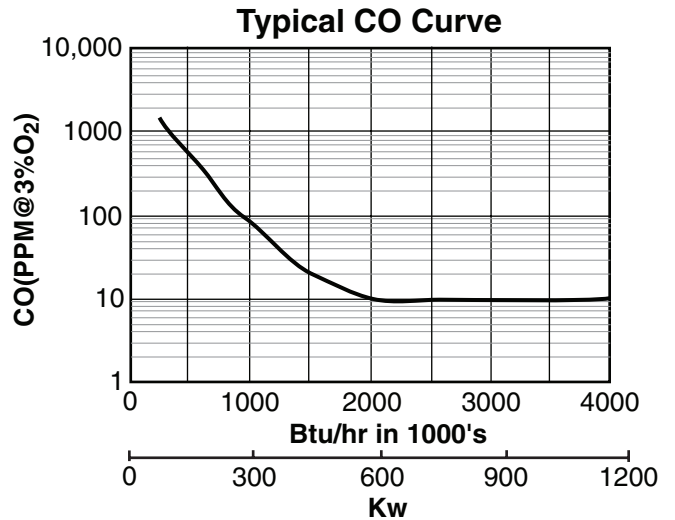
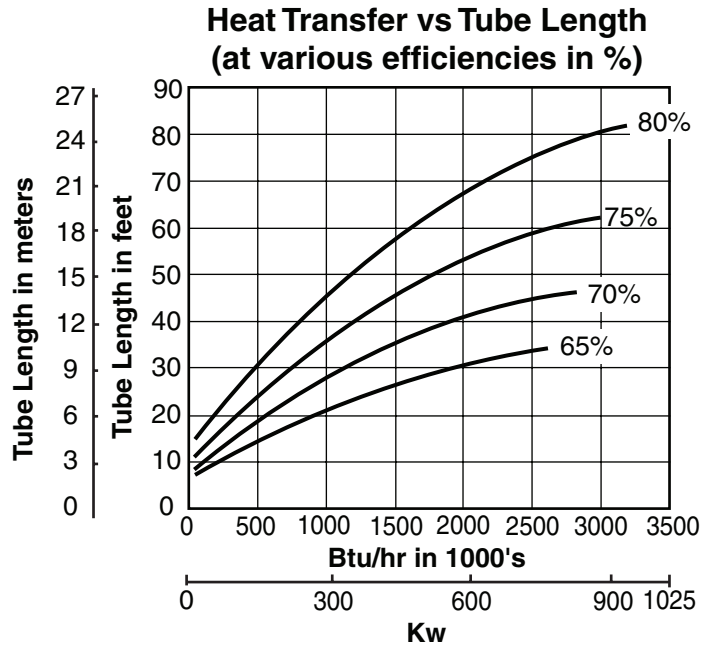
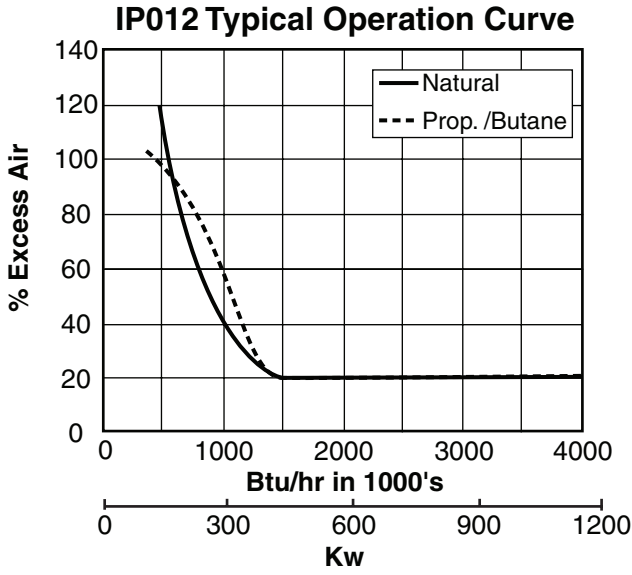

Dimensions & Specifications

Dimensions in mm (inches)

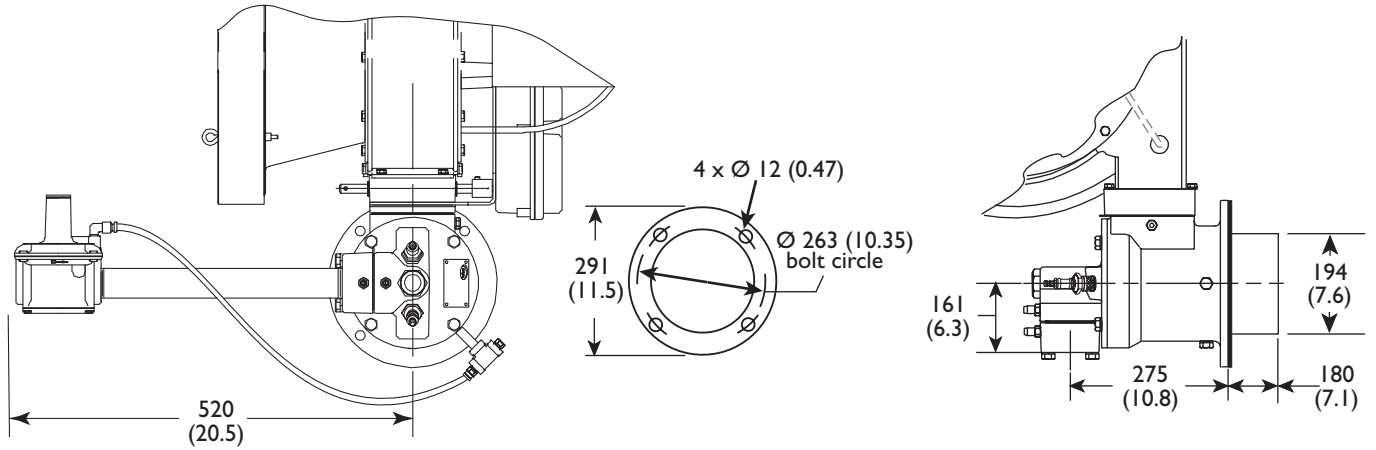
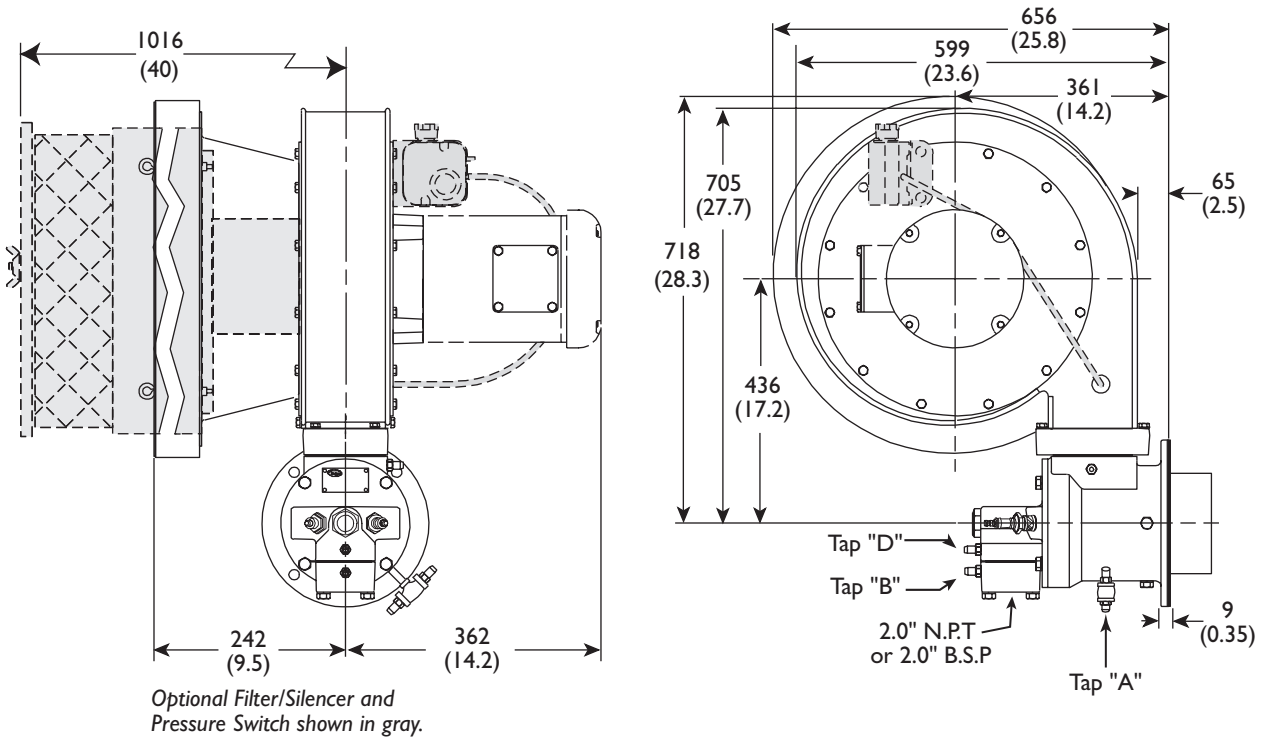

Orientation

Upright

Inverted

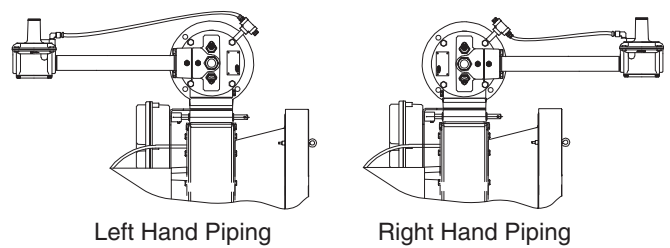
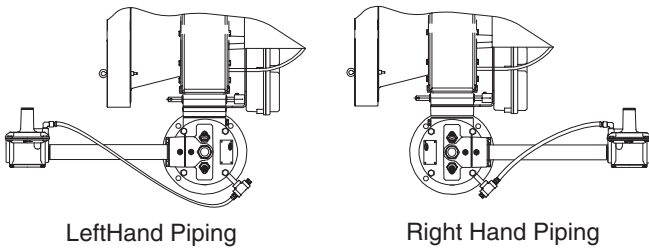



Offered By:

Power Equipment Company
2011 Williamsburg Road
Richmond, Virginia 23231
Phone (804) 236-3800
Fax (804) 236-3882

www.peconet.com